

# What can and cannot go in each bin



**Merri-bek**  
City Council

## MIXED RECYCLING BIN

Collected fortnightly

✓ Yes



Steel tins



Aluminium cans, foil



Paper, newspaper, magazines



Cardboard, egg cartons



Plastic bottles and containers

✗ No



Plastic bags or soft plastics

- Put your recycling in the bin loose, not in bags.
- Items must be empty.
- Flatten cardboard boxes to save space.

## GLASS RECYCLING BIN

Collected every 4 weeks

✓ Yes



Glass bottles



Glass jars

✗ No



Drinking glasses



Loose lids and bottle caps

- For glass bottles and jars only.
- Put your glass bottles and jars in the bin loose, not in bags.
- Glass bottles and jars must be empty.
- Jar lids and bottle caps must be firmly attached.
- Put loose lids and bottle caps in the general rubbish bin.

## FOOD AND GARDEN ORGANICS BIN

Collected weekly

✓ Yes



Fruit and vegetable scraps



Meat, bones, seafood



Bread, meal leftovers

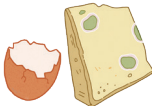

Cheese, egg shells



Plants, grass, weeds



Leaves, twigs

✗ No



Compostable or plastic bags

- Food scraps and garden clippings only.
- Put in your bin loose or use paper towels to wrap food waste.
- All packaging must be removed, including fruit stickers.
- Compostable bags are not accepted.

## GENERAL RUBBISH BIN

Collected weekly

✓ Yes



Nappies, wet wipes



Broken glassware, crockery

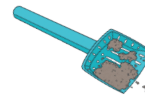

Kitty litter, animal droppings



Old clothing, shoes or textiles



Bagged rubbish

✗ No



E-waste or hazardous materials

- Use this bin only for items that can't be reused or recycled.
- Use our A to Z guide to find out how to dispose of other household waste: [merri-bek.vic.gov.au/azguide](http://merri-bek.vic.gov.au/azguide)

More information:  
[merri-bek.vic.gov.au/bins](http://merri-bek.vic.gov.au/bins) or call 9240 1111



**Sustainability**  
Victoria

