

# Craigieburn Railway Line Shared User Path between Gaffney Street & Bothwell Street Pascoe Vale

FOR CONTINUATION REFER DRG. C3101

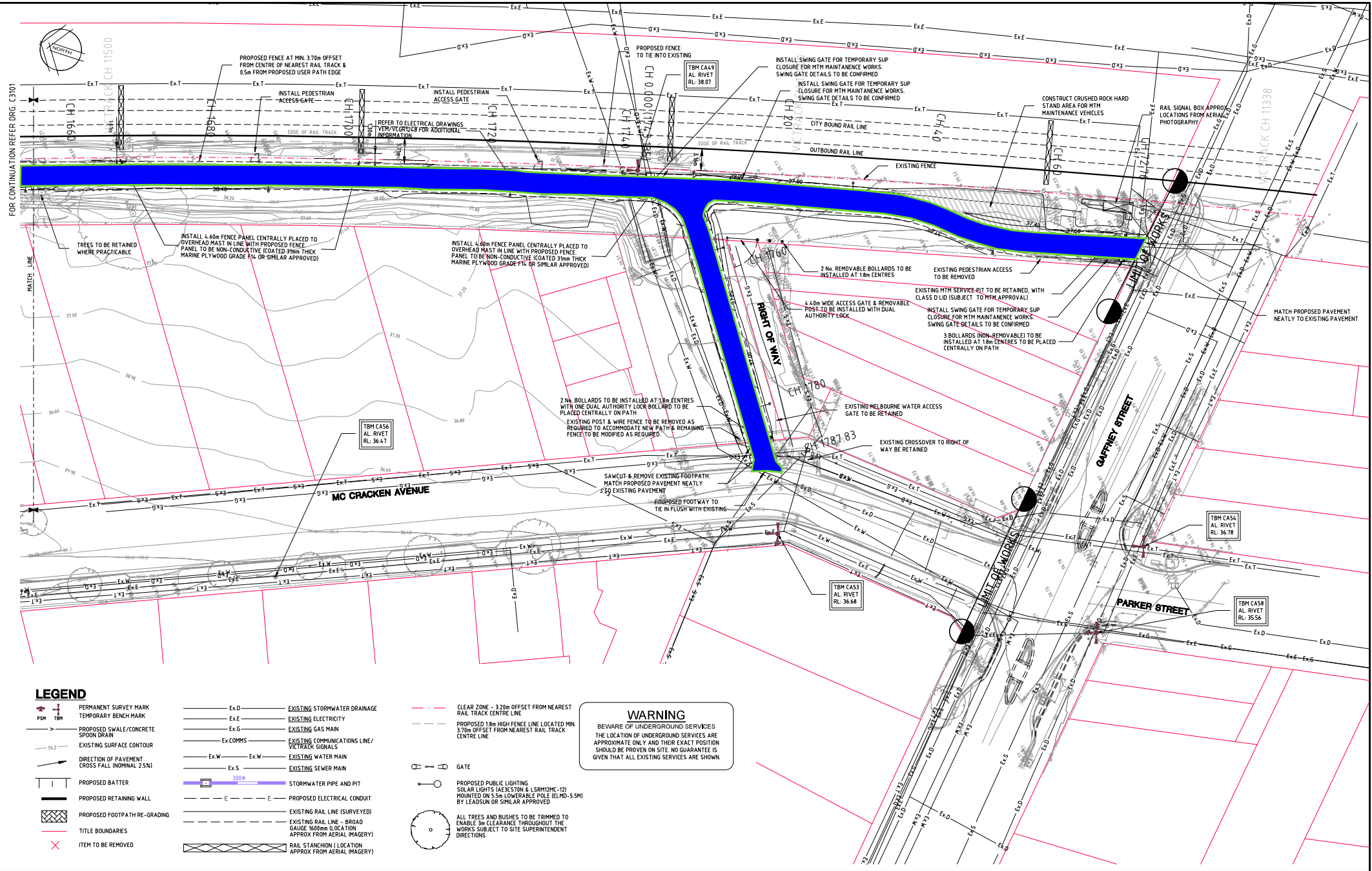

## LEGEND

	PERMANENT SURVEY MARK		EXISTING STORMWATER DRAINAGE		CLEAR ZONE - 3.20m OFFSET FROM NEAREST RAIL TRACK CENTRE LINE
	TEMPORARY BENCH MARK		EXISTING ELECTRICITY		PROPOSED 1.8m HIGH FENCE LINE LOCATED MIN. 3.70m OFFSET FROM NEAREST RAIL TRACK CENTRE LINE
	PROPOSED SWALE/CONCRETE SPOON DRAIN		EXISTING GAS MAIN		GATE
	EXISTING SURFACE CONTOUR		EXISTING COMMUNICATIONS LINE/ VET TRACK SIGNALS		PROPOSED PUBLIC LIGHTING SOLAR LIGHTS (AEC SYSTEM & LSR/MTC-12) MOUNTED ON 5.5m LOWERABLE POLE (BLIND-5.5M) BY LEADSUN OR SIMILAR APPROVED
	DIRECTION OF PAVEMENT (CROSS FALL NOMINAL 2.5%)		EXISTING WATER MAIN		ALL TREES AND BUSHES TO BE TRIMMED TO ENABLE 3m CLEARANCE THROUGHOUT THE WORKS SUBJECT TO SITE SUPERINTENDENT DIRECTIONS
	PROPOSED BATTER		EXISTING SEWER MAIN		
	PROPOSED RETAINING WALL		STORMWATER PIPE AND PIT		
	PROPOSED FOOTPATH RE-GRADING		PROPOSED ELECTRICAL CONDUIT		
	TITLE BOUNDARIES		EXISTING RAIL LINE (SURVEYED)		
	ITEM TO BE REMOVED		EXISTING RAIL LINE - BROAD GAUGE 1600mm (LOCATION APPROX FROM AERIAL IMAGERY)		
			RAIL STANCHION (LOCATION APPROX FROM AERIAL IMAGERY)		

## WARNING

BEWARE OF UNDERGROUND SERVICES  
THE LOCATION OF UNDERGROUND SERVICES ARE APPROXIMATE ONLY AND THEIR EXACT POSITION SHOULD BE PROVEN ON SITE. NO GUARANTEE IS GIVEN THAT ALL EXISTING SERVICES ARE SHOWN.

