

# Draft Concept Plan

## Park Close to Home - Frith Street Brunswick

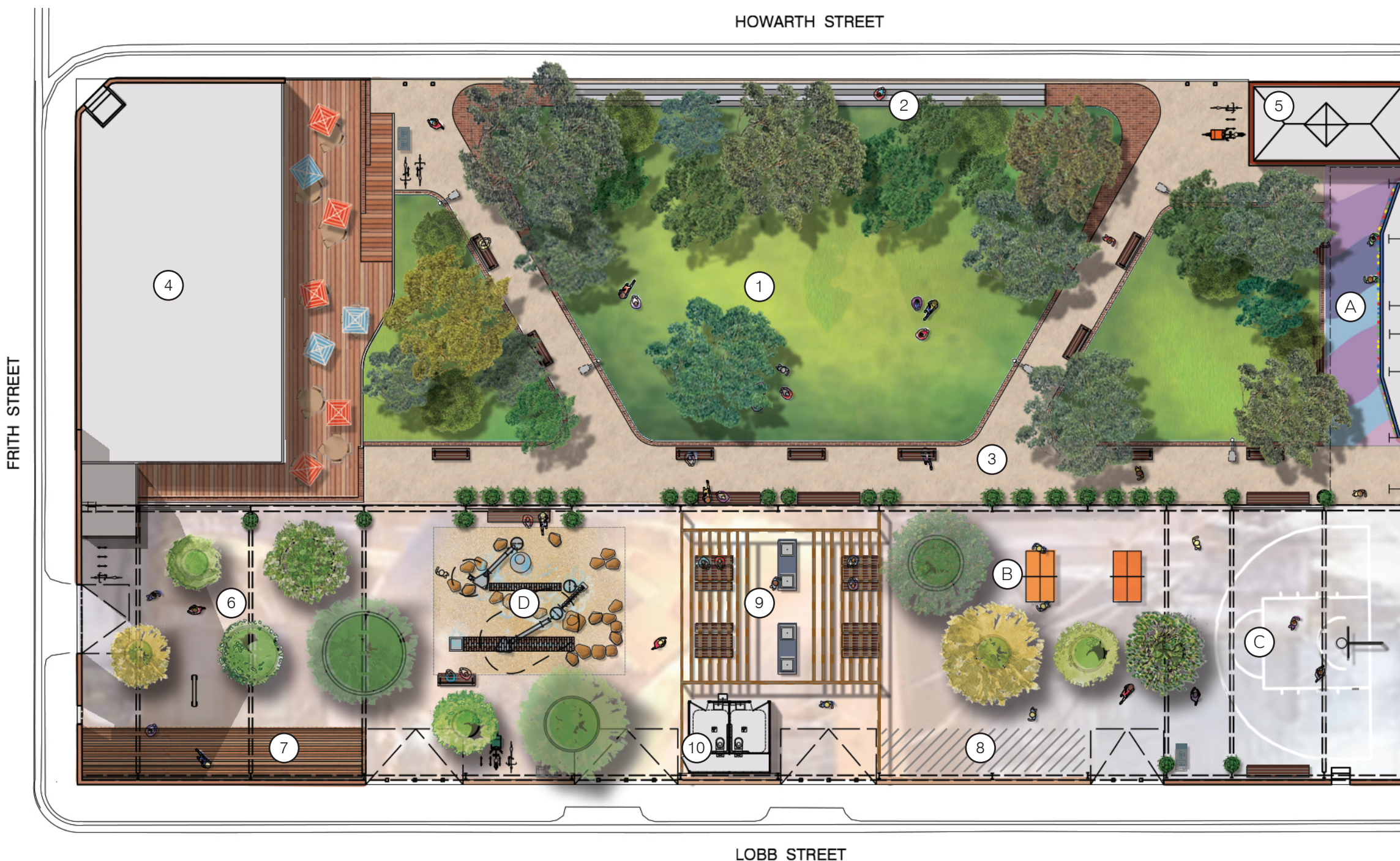

- ① Lawn
- ② North-facing sun steps
- ③ Gravel paths and bench seating
- ④ Heritage facade & building
- ⑤ Electrical sub-station
- ⑥ Historical interpretation & signage
- ⑦ Morning sun deck
- ⑧ Food truck parking space
- ⑨ BBQs, picnic tables and shelter
- ⑩ Public toilet

In these areas, alternative uses have been nominated for community consultation and feedback:

- Ⓐ A.1 Bouldering wall with rubber mats  
A.2 Small enclosed dog off-leash area  
A.3 Community garden  
A.4 More green space
- Ⓑ B.1 Ping pong tables  
B.2 Fitness equipment
- Ⓒ C.1 Basketball half-court  
C.2 Mini Futsal half-court
- Ⓓ D.1 Water play  
D.2 Nature play  
D.3 Playful climbing structures  
D.4 Contemporary play equipment

A historic local park

The northern side of the park features green grass and trees with generous seating and pathways. The southern side enhances the site's industrial heritage within the former steel foundry floor, walls, and roof frame.



Park Close to Home - Frith Street Brunswick is supported by the Victorian Government through the DELWP Local Parks Program